

THE COPYRIGHT OF THESE DRAWINGS AND OF ALL ENCLOSURES
ENTRUSTED TO THE RECIPIENT PERSONALLY REMAINS THE EXCLUSIVE
PROPERTY OF THIS FIRM.WITHOUT OUR WRITTEN CONSENT THEY
MAY NOT BE COPIED OR REPRODUCED OR DELIVERED OR MADE
KNOWN TO THIRD PARTIES

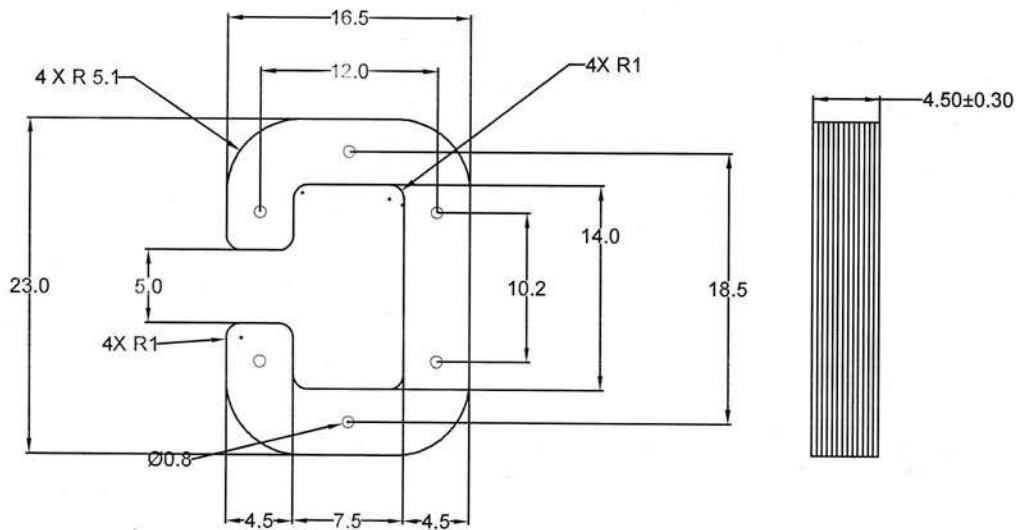

Note:

1. No. of laminations: 13
2. General Tolerance: 0.1mm
3. EP Coating : 10 to 20 micron

Contact us at: <https://www.ctscorp.com/Contact-Us>

UNITS: MM

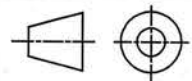

Description: Automotive core C-5mm

Material: SiFe X 0.35mm thick

SCALE

PREPARED

Hixen

④ 4000

4/4/18

CHECKED

Preeti

Love

4/4/19

APPROVED

HIS



4	4	18
---	---	----

Drawing No.

Z-F-CR-032-R0

[illegible]

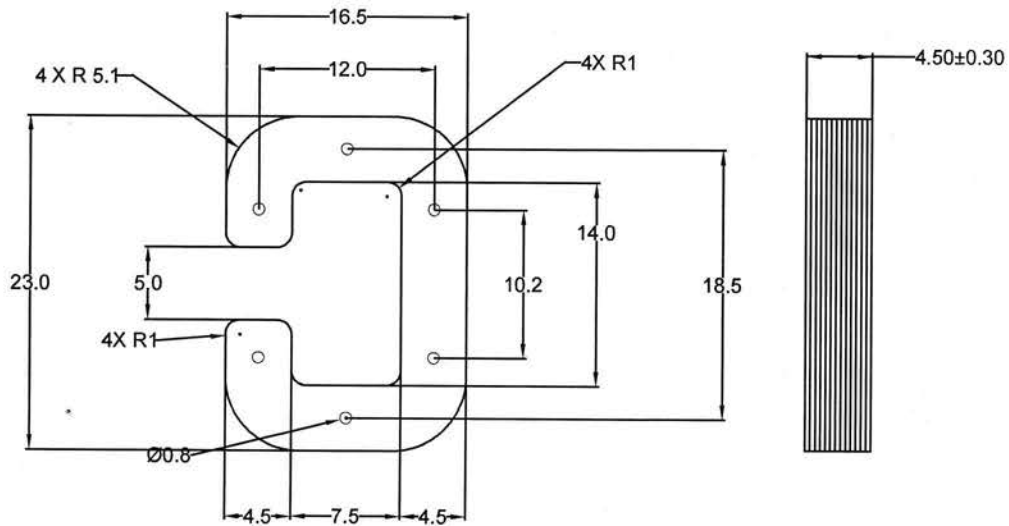

Note:

1. No. of laminations: 13
2. General Tolerance: 0.1mm

Contact us at: <https://www.ctscorp.com/Contact-Us>

UNITS: MM

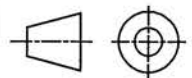

Description: Automotive core C-5mm

SCALE

PREPARED

[Signature]

14/3/18

CHECKED

[Signature]

14/3/18

Material: 48 NiFe X 0.345mm thick

NTS

APPROVED

[Signature]

14/3/18

SR.NO.	Modifications	NAME	SR	DATE

Drawing No.
Z-C-CR-163-R0