



CER1007A

1515-1615MHz BPF

Features

- Extra low-loss

Applications

- Wireless Infrastructure applications

Description

Surface mount ceramic bandpass filter provides superior insertion loss, reliability, as well as both peak and average power handling compared to other bandpass filter technologies.

Electrical Specifications

Parameter	Frequency (MHz)	Typical at 25°C	Spec. at 25°C	Spec. over -40°C to +85°C
Nominal Impedance	-	50 ohms	-	-
Average Input Power	-	-	-	2.0 Watt max
Peak Input Power	-	-	-	20 Watt max

Input-Output Response

Passband Insertion Loss	1515 - 1615	0.6 dB	0.7 dB max	0.8 dB max
Passband Ripple	1515 - 1615	0.2 dB	0.4 dB max	0.5 dB max
Passband Return Loss	1515 - 1615	14 dB	12 dB min	12 dB min
Attenuation:	1 - 1400	30 dB	20 dB min	20 dB min
	1800 - 2200	28 dB	20 dB min	20 dB min

Note: CTS tests each unit to the critical specifications above. Subsequent audits may deviate due to repeatability among different test systems which shall not exceed these allowances.

Specification Allowance	
Insertion Loss	0.1 dB
Return Loss	1.0 dB
Attenuation	1.0 dB



Part Dimensions: 14.8 x 6.0 x 6.0 mm • 2.5g
Materials: Ag plated ceramic block

Mechanical Drawing

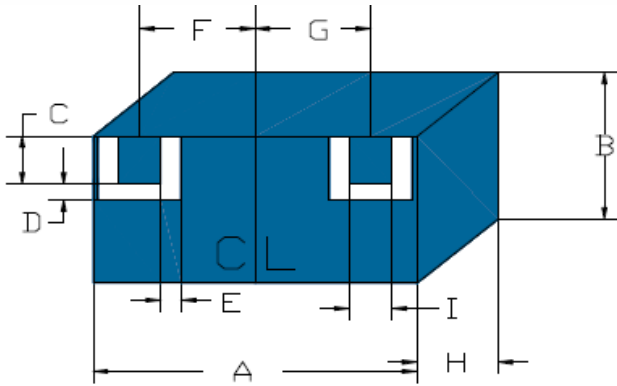

Dim.	Nominal (mm)	Tolerance (±mm or Max)
A	14.74	max
B	6.00	max
C	1.02	0.13
D	0.64	0.13
E	0.64	0.13
F	5.69	0.13
G	5.69	0.13
H	6.00	0.13
I	1.02	0.13

PCB Layout

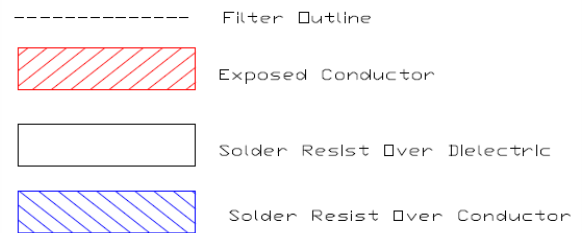
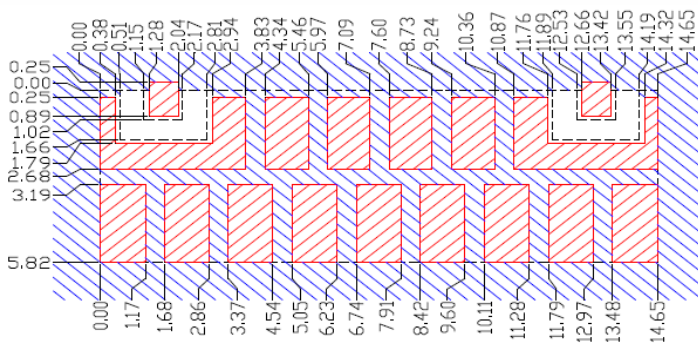

Packaging and Marking

Dimension	Units	Spec.	Product Marking
Reel Diameter	mm	330	CTS
Reel Weight	kg	1.7	007
Reel Quantity	ea.	500	YWW

CTS
007
YWW

Customer Feed Direction → → →

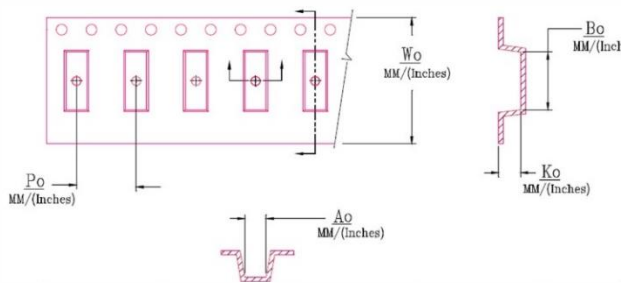

W_0	A_0	B_0	K_0	P_0
0.945 in 24.0 mm	0.242 in 6.15 mm	0.591 in 15.0 mm	0.244 in 6.2 mm	0.472 in 12.0 mm

Electrical Response

