

MCB1970A - Preliminary

19.20-20.20GHz mmWave ClearPlex Bandpass Filter

Features

- High-Q Low-Loss with High Rejection

Applications

- mmWave carrier-grade Infrastructure applications

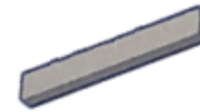

Part Dimensions: 13.6 × 3.2 × 1.3 mm • <1.0 g

Description

Surface mount bandpass filter with I/Os that can interface to micro-strip transmission lines on the top-layer of customer PCBs. Superior rejection, insertion loss, reliability, temperature stability as well as both peak and average power handling compared to other mmWave bandpass filter technologies.

Electrical Specifications

Parameter	Frequency (GHz)	Typical at 25°C	Spec. at 25°C	Spec. over -40°C to +85°C
Nominal Impedance	-	50 ohms	-	-
Average Input Power	-	-	-	5.0 Watt max
Peak Input Power	-	-	-	50 Watt max
Input-Output Response				
Passband Insertion Loss	19.20 - 20.20			3.0 dB Max
Passband Ripple	19.20 - 20.20			1.2 dB Max
Passband Return Loss	19.20 - 20.20			14 dB Goal 12 dB Min
Attenuation:	18.20			40 dB Min
	21.20			40 dB Goal

Note: CTS tests each unit to the critical specifications above. Subsequent audits may deviate due to repeatability among different test systems which shall not exceed these allowances.

Specification Allowance

Insertion Loss	0.1 dB
Return Loss	1.0 dB
Attenuation	1.0 dB

Mechanical Drawing

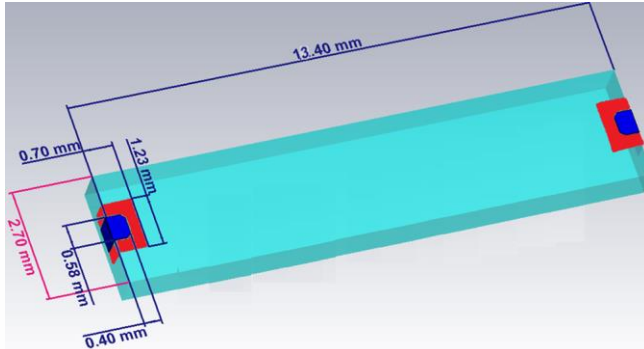

Dim.	Nominal (mm)	Tolerance (±mm or Max)
A	13.40	0.20
B	2.60	0.30
C		
D		
E		
F		
G		
H	1.10	0.20
I		
J		

PCB Layout

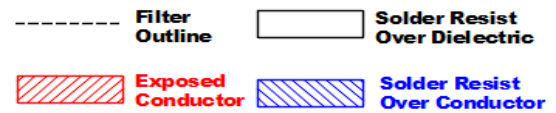
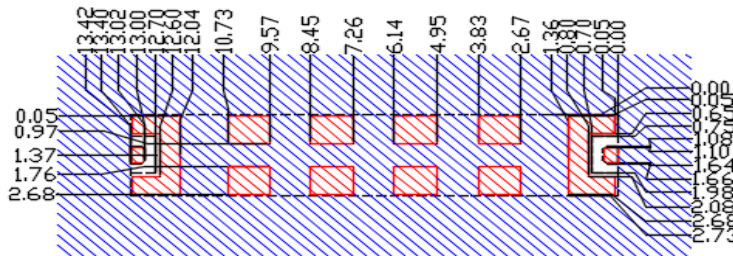

Packaging and Marking

Dimension	Units	Spec.	Product Marking
Reel Diameter	mm	330	No marking on the filters
Reel Weight	kg	x.x	
Reel Quantity	ea.	Xxx	

Customer Feed Direction → → →

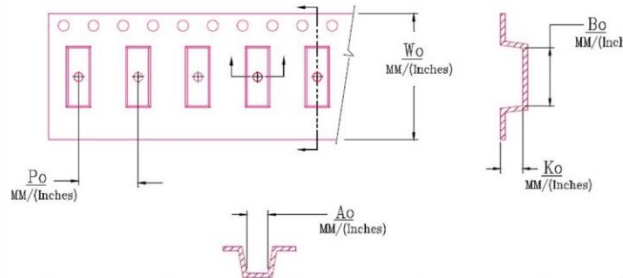

W_0	A_0	B_0	K_0	P_0
1.732 in 44.0 mm	x.xxx in x.xx mm	x.xxx in x.xx mm	x.xxx in x.xx mm	x.xxx in x.xx mm

Electrical Response

