

# Contact Transducers

## Protective Face Transducers

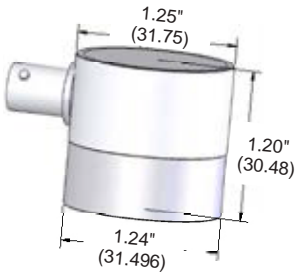

Integral replaceable Protective Face Transducers, which combines three different types of wear surfaces: a soft protective membrane, a high temperature delay line (up to 550°F), and an expendable protective wear cap for extremely rough surfaces. All Protective Face Transducers are general purpose (GP).



FREQUENCY (MHz)	SIZE INCHES (mm)			
	0.5 (12.7)	0.75 (19.05)	1.0 (25.4)	1.125 (28.575)
0.5	–	CP0.506	CP0.508	CP0510
1.0	CP0104	CP0106	CP0108	CP0110
2.25	CP0204	CP0206	CP0208	CP0210
3.5	CP0304	CP0306	–	–
5.0	CP0504	CP0506	CP0508	–

## Options

DESCRIPTION	SIZE INCHES (mm)			
	0.5 (12.7)	0.75 (19.05)	1.0 (25.4)	1.125 (28.575)
Membranes (Doz)	VPM12-04	VPM12-06	VPM12-08	VPM12-10
High Temp Delay	VHT-04	VHT-06	VHT-08	VHT-10
Wear Cap (Doz)	VWC-04	VWC-06	VWC-08	VWC-10
Delay Ring	VRC-04	VRC-06	VRC-08	VRC-10